



**ECHOCOUSTIC® PRODUCT SHEET**

# TABLE OF CONTENT



<b>TABLE OF CONTENT</b> .....	2
<b>TENDER TEXT</b> .....	3
<b>DATA SHEET</b> .....	4
<b>COLORS</b> .....	5
<b>DIMENSIONS ECHOCOUSTIC®</b> .....	6
<b>INSTALLATION GUIDE ECHOGLUE®</b> .....	8
<b>INSTALLATION GUIDE ECHOPROFILE®</b> .....	9
<b>CLEANING &amp; CARE</b> .....	10

## DESCRIPTION

EchoCoustic® is a high-quality sound absorber, which is mounted on walls and ceilings without an air gap and thus achieves a sensational room sound absorption coefficient of 85%. The 3-layer EchoCoustic® has a material thickness of 25mm and consists of 100% PET, of which 50% is recycled. The surface impresses with its beautiful high-tech felt and is available in 34 colours. The middle layer gives the EchoCoustic® its stiffness and makes the product pinable. The base is responsible for the excellent acoustic values.

Mounting the EchoCoustic® is extremely simple. Together with the EchoProfile® 25mm EDGE, installation is even possible without adhesive. Since the EchoCoustic® is mounted directly on the wall or ceiling, the loss of space is very low despite the highest acoustic performance.

The EchoCoustic® is a direct answer to questions of ecological and economic sustainability that arise in contemporary interior design, interior decoration and renovation.

## DIMENSIONS

Size: 2720mm (± 5mm) x 1210mm (±10mm)

Thickness: 25mm ± (2mm)

Weight: 2650g/m<sup>2</sup> (± 10%)

## ACOUSTIC PERFORMANCE

The EchoCoustic® 25mm panel achieves excellent sound absorption of  $\alpha_w$  0.8 and NRC 0.85 when mounted without an air gap and is ideal for medium and high frequency absorption.

## INSTALLATION

- Quick installation with EchoGlue® contact adhesive
- Optional mounting with EchoProfile® anodized aluminum profiles
- Suitable for use indoors and outdoors
- Very easy to trim with a knife

## MATERIAL PROPERTIES

- Extremely robust and shockproof
- Very high colour fastness of the all-round homogeneous textile surface available in 34 colours
- Dimensionally stable up to 50°C and 95%rH
- Flame retardant. B-s1,d0 certified according to EN 13501
- Extremely low volatile organic compounds below < 0.5mg/m<sup>2</sup>/h (during 7 days), certified according to ASTM D5116
- Free of formaldehyde, certified according to AATCC 112-2003
- Alkalinity: pH: 7.8 (pH 7 is neutral)
- Melting point: 250 °C
- Decomposition Temp: > 250 °C
- Thermal resistance R = 0.7
- Heat transfer coefficient U = 1.41

## CLEANING

Can be cleaned dry and damp with chlorine or hydrogen peroxide.

## ENVIRONMENT

- 100% PET with a content of over 50% from recycled PET bottles
- 100% recyclable
- Certified by manufacturer according to Greentag Greenrate Level A

## DISPOSAL

The product is recyclable as part of EchoJAZZ's stewardship programme.

# DATA SHEET



<b>DESCRIPTION</b>	EchoCoustic® 25mm																																												
<b>DINEMSIONS</b>	2720mm (± 5mm) x 1210mm (± 10mm)																																												
<b>COMPOSITION</b>	100% PET (> 50% recycled PET)																																												
<b>PET BOTTLES* PER PANEL</b>	181 PET Bottles *The number of PET bottles refers to 500ml PET bottles with a bottle weight of 24g.																																												
<b>WEIGHT</b>	2650g/m <sup>2</sup> (± 10%)																																												
<b>THICKNESS</b>	25mm (± 2mm)																																												
<b>LIGHT FASTNESS ISO 105-B02-1994</b>	> 6																																												
<b>FIRE RATING EN 13501</b>	B-s1, d0																																												
<b>VOC EMISSIONS ASTM D5116</b>	< 0.5mg/m <sup>2</sup> /h																																												
<b>FORMALDEHYD EMISSIONS AATCC TM 124-2003</b>	< 100ppm																																												
<b>ENVIRONMENTAL CERTIFICATES</b>	Certified by manufacturer according to Greentag Greenrate Level A																																												
<b>THERMAL PERFORMANCE</b>	Thermal resistance: R = 0.7 Heat transfer coefficient: U = 1.43																																												
<b>ACOUSTIC ABSORPTION AS/ISO 354 ASTM C423-99</b>	aw = 0.80 (0mm air gap) NRC = 0.85 (0mm air gap)																																												
<b>COLORS</b>	34																																												
<b>ACOUSTIC ABSORPTION GRAPH</b>	<table border="1"> <caption>Acoustic Absorption Graph Data Points (Estimated)</caption> <thead> <tr> <th>Frequency [Hz]</th> <th>Sound Absorbance Coefficient</th> </tr> </thead> <tbody> <tr><td>100</td><td>0.05</td></tr> <tr><td>125</td><td>0.10</td></tr> <tr><td>150</td><td>0.15</td></tr> <tr><td>175</td><td>0.25</td></tr> <tr><td>200</td><td>0.35</td></tr> <tr><td>250</td><td>0.55</td></tr> <tr><td>300</td><td>0.65</td></tr> <tr><td>350</td><td>0.75</td></tr> <tr><td>400</td><td>0.80</td></tr> <tr><td>500</td><td>0.85</td></tr> <tr><td>630</td><td>0.90</td></tr> <tr><td>800</td><td>0.95</td></tr> <tr><td>1000</td><td>1.00</td></tr> <tr><td>1250</td><td>1.05</td></tr> <tr><td>1500</td><td>1.00</td></tr> <tr><td>1750</td><td>1.00</td></tr> <tr><td>2000</td><td>0.95</td></tr> <tr><td>2500</td><td>0.95</td></tr> <tr><td>3000</td><td>0.95</td></tr> <tr><td>3500</td><td>0.95</td></tr> <tr><td>4000</td><td>0.95</td></tr> </tbody> </table>	Frequency [Hz]	Sound Absorbance Coefficient	100	0.05	125	0.10	150	0.15	175	0.25	200	0.35	250	0.55	300	0.65	350	0.75	400	0.80	500	0.85	630	0.90	800	0.95	1000	1.00	1250	1.05	1500	1.00	1750	1.00	2000	0.95	2500	0.95	3000	0.95	3500	0.95	4000	0.95
Frequency [Hz]	Sound Absorbance Coefficient																																												
100	0.05																																												
125	0.10																																												
150	0.15																																												
175	0.25																																												
200	0.35																																												
250	0.55																																												
300	0.65																																												
350	0.75																																												
400	0.80																																												
500	0.85																																												
630	0.90																																												
800	0.95																																												
1000	1.00																																												
1250	1.05																																												
1500	1.00																																												
1750	1.00																																												
2000	0.95																																												
2500	0.95																																												
3000	0.95																																												
3500	0.95																																												
4000	0.95																																												

# COLORS



## ECHOCOUSTIC® STANDARD COLORS



## ECHOCOUSTIC® SPECIAL COLORS

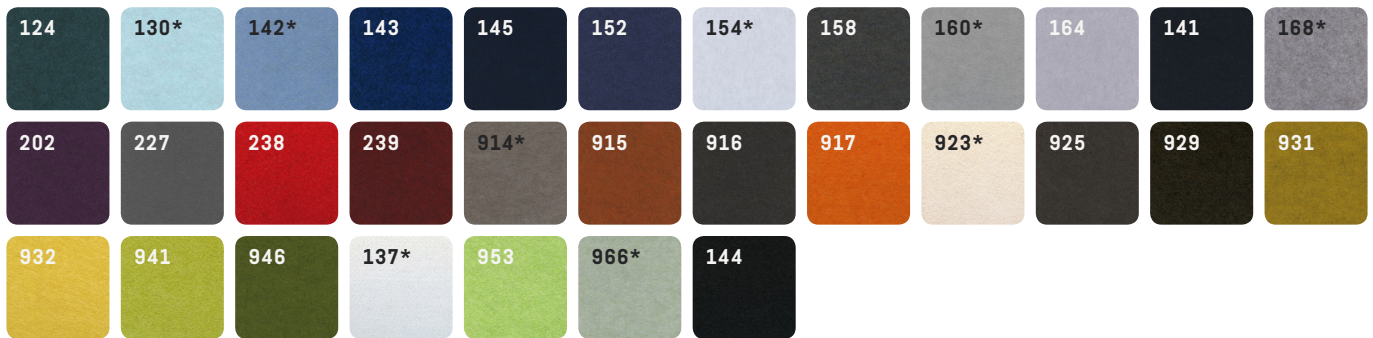

\*137, 948, 142, 923, 164, 966, 168, 154, 160, 914 & 130 are supplied with white core, all other colours are supplied with black core. Due to the nature of the material, surface and colour variations are possible.

# DIMENSIONS ECHOCOUSTIC®



ECHOCOUSTIC® 25MM  
PET25REC000000A  
2720 x 1210 x 25mm

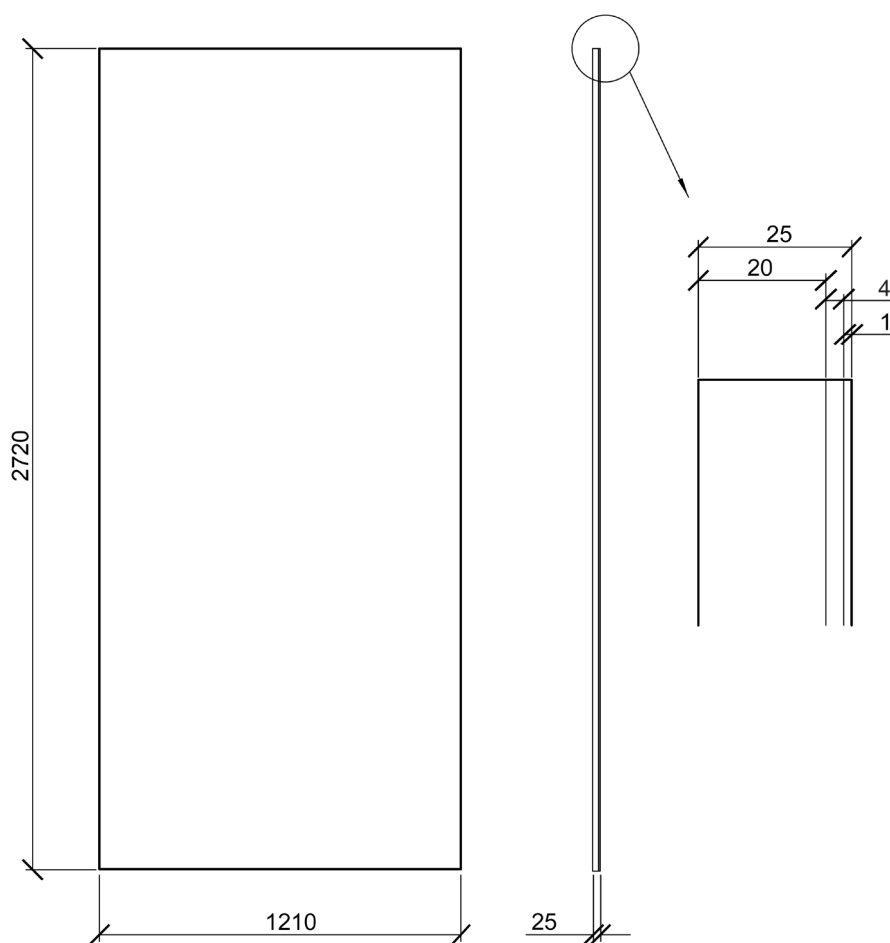
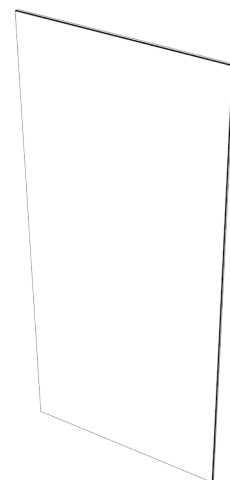

# DIMENSIONS ECHOPROFILE®



ECHOPROFILE® 25MM EDGE  
EDG25END000000A  
16mm x 27.8mm x 2750mm

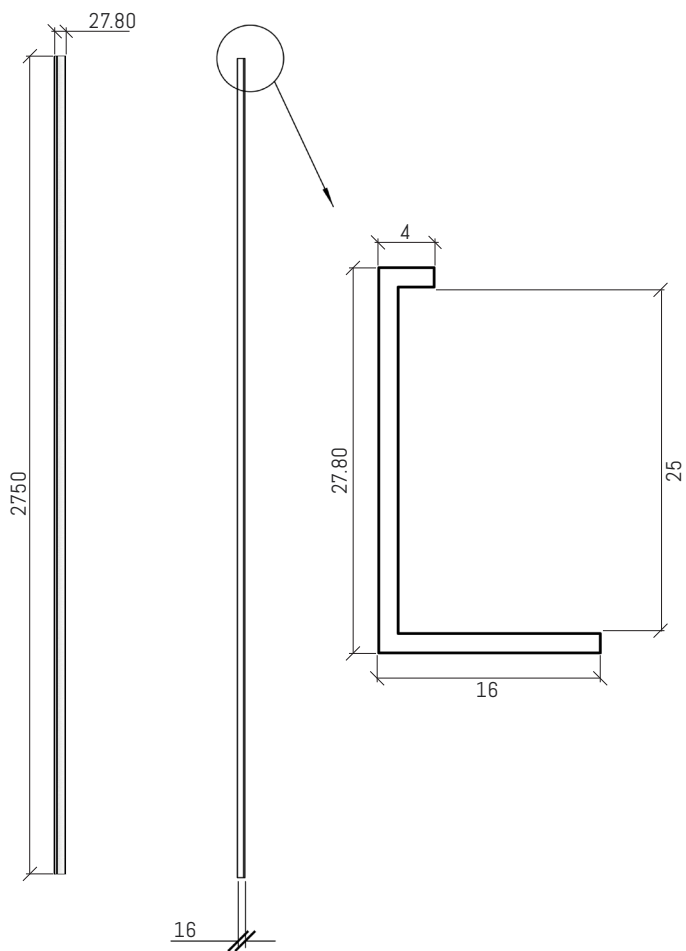
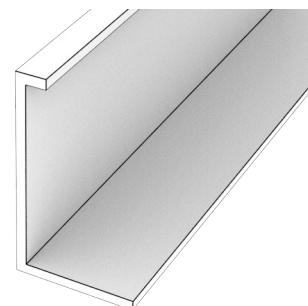

# INSTALLATION GUIDE ECHOGLUE®



## ECHOGLUE®

EchoGlue® is a sprayable contact adhesive for interior fittings, floor installation, etc. Thanks to its excellent adhesive strength, EchoGlue® is ideal for most permanent joints. The spray adhesive has been specially developed for professional applications. After curing, the adhesive is non-flammable.

## FUNCTION/USE

Shake well before use. Hold the spray nozzle approx. 10 centimeters above the surface. Apply the adhesive evenly in strips on both surfaces which should be glued together. Do not overlap the adhesive stripes. To ensure optimum results, EchoGlue® should be used at temperatures of at least 10 - 25°C (ideally 20°C). Always apply the adhesive to both surfaces and allow to dry for approx. 1-2 minutes until the solvents have completely evaporated. The open time is approx. 4 hours. With difficult materials, in the edge area or very absorbent substrates, such as blockboard or plywood, a double application is recommended. Press both surfaces firmly together (pressure approx. 2.5 to 3 kg/cm<sup>2</sup>) to ensure a good bond. Bonded materials can be processed immediately. The final curing of the adhesive takes place after approx. 24 hours.

## DISCLAIMER

We always recommend a prior test bonding with your materials. It is the responsibility of the user to verify that EchoGlue® is suitable for the application. As softening agents can damage or destroy the adhesive, we recommend that you consult our technical department before bonding plasticized products, such as PVC, CV coverings, artificial leather, etc., for testing their materials.

## USER INFORMATION

To prevent the spray nozzle from clogging: After finishing work, turn the can over and spray until only gas escapes.

## IMPORTANT NOTES

For commercial users only. Vapours can form explosive mixtures with air. Use only in a well-ventilated environment. In case of watery eyes or headaches and dizziness, increase the supply of fresh air or leave the room. For your own safety, wear approved respirator, eye, hand and body protection equipment. Avoid contact with eyes, skin and clothing. Read safety data sheet and user instructions before use.

### 1. SPRAY ECHOGLUE® ONTO BACKSIDE OF ECHOCOUSTIC®

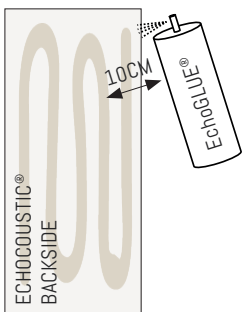

### 2. SPRAY ECHOGLUE® ONTO WALL

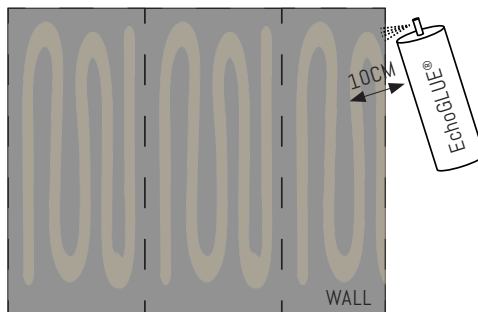

### 3. PRESS ECHOCOUSTIC® AGAINST WALL

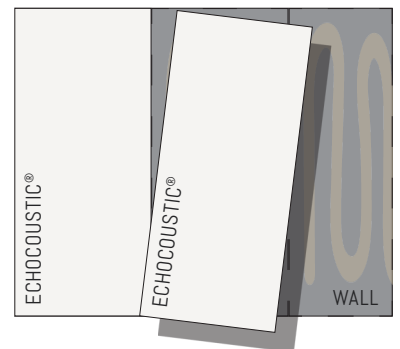



# INSTALLATION GUIDE ECHOPROFILE®



ECHOCOUSTIC® 25MM EDGE  
EDG25END000000A  
16mm x 27.8mm x 2750mm

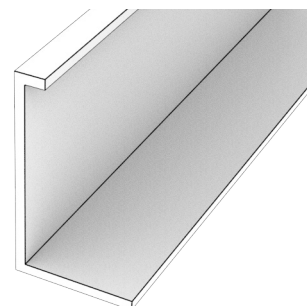

## 1. PRE-DRILLING HOLES AND INSERTING DOWELS

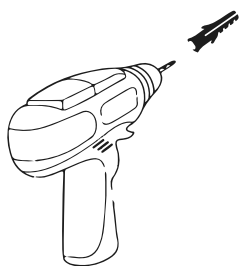

## 2. MOUNTING ECHOPROFILE® EDGE WITH SCREWS

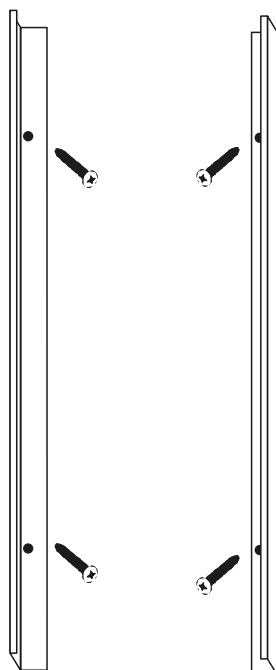
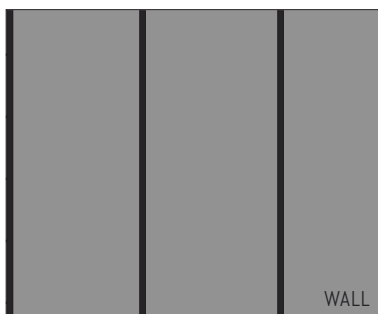

## 3. PRESS ECHOCOUSTIC® PANEEL BETWEEN MOUNTED PROFILES

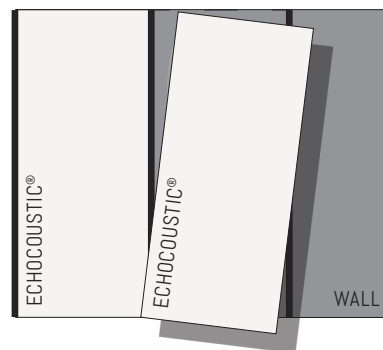

# CLEANING & CARE

Please make first a cleaning attempt on an inconspicuous spot. Follow the instructions of the cleaning agents.

## DUSTER/VACUUM CLEANER

For dusting use duster or vacuum cleaner.

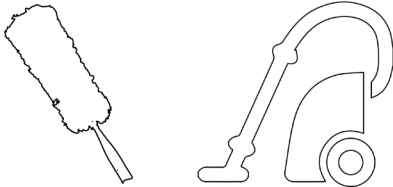

## SPARKLING WATER

For slight contamination apply sparkling water on polluted area. Wipe carefully with a sponge.

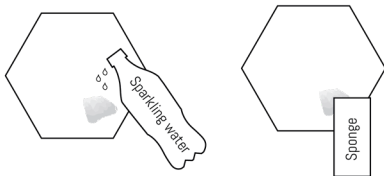

## UPHOLSTERY CLEANER

For medium contamination apply upholstery cleaner on polluted area. Wipe carefully with a sponge.

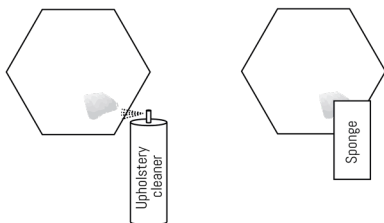

## BLEACH

For heavy contamination apply bleach as chlorine or hydrogen peroxide on polluted area. Wipe carefully with a sponge and sparkling water.

